

LEGEND

ZONE BOUNDARIES	—
TOPOGRAPHIC CONTOURS	— 1724
AERIAL CONTOURS	— 1600
SECTION LINES	—
MEDIUM DUTY ROAD	—
LIGHT DUTY ROAD	—
UNIMPROVED DIRT ROAD	—
STATE ROUTE	— 59
ULTIMATE RUNWAY	—

- NOTES**
1. TOPOGRAPHIC CONTOUR INTERVALS ARE 10 FEET. DATUM IS MEAN SEA LEVEL ELEVATION. TOPOGRAPHY BY PHOTOGRAMMETRIC METHODS FROM AERIAL PHOTOGRAPHS TAKEN 1965; REID CHECKED 1967. 1927 NORTH AMERICAN DATUM.
 2. THE AERIAL CONTOURS ILLUSTRATE THE HEIGHT LIMITATIONS WITHIN EACH ZONE.
 3. A SLOPE, SUCH AS 40:1, EXPRESSES THE HORIZONTAL DISTANCE OF 40 FEET TO THE VERTICAL OF 1 FOOT.
 4. EXISTING TOPOGRAPHICAL SYMBOLS ARE THOSE USED BY U.S. GEOGRAPHICAL SURVEY.
 5. IN THOSE AREAS WHERE EXISTING TERRAIN OR TREES PENETRATE ONE OR MORE OF THE IMAGINARY SURFACES, THE HEIGHT OF THE STRUCTURES SHALL BE RESTRICTED ONLY TO THE HEIGHT OF THE "CANOPY" WHICH PROVIDES A NATURAL SHIELD TO THE STRUCTURES.
 6. ELEVATIONS OF HIGHEST POINT OF RUNWAY IS 1623.6. SEE SECTION A-A.

NON CONFORMING AIRSPACE ZONING
NONE

I hereby certify that this plan, specification or report was prepared by me or under my direct supervision and that I am a duly Registered Professional Engineer under the laws of the state of Minnesota.

Charles J. Johnson
Date: 2/16/79 Reg. No. 173020

SLAYTON AIRPORT ZONING PLAN

SLAYTON, MINNESOTA
SLAYTON - MURRAY COUNTY AIRPORT ZONING BOARD

APPROVAL	DATE
APPROVAL	DATE
APPROVAL	DATE
APPROVAL	DATE
APPROVAL	DATE

REVISIONS		NO.	DESCRIPTION	DATE
1	APPROACH ZONE			

KOEHLIN LIGHTOWLER JOHNSON
ARCHITECTS ENGINEERS

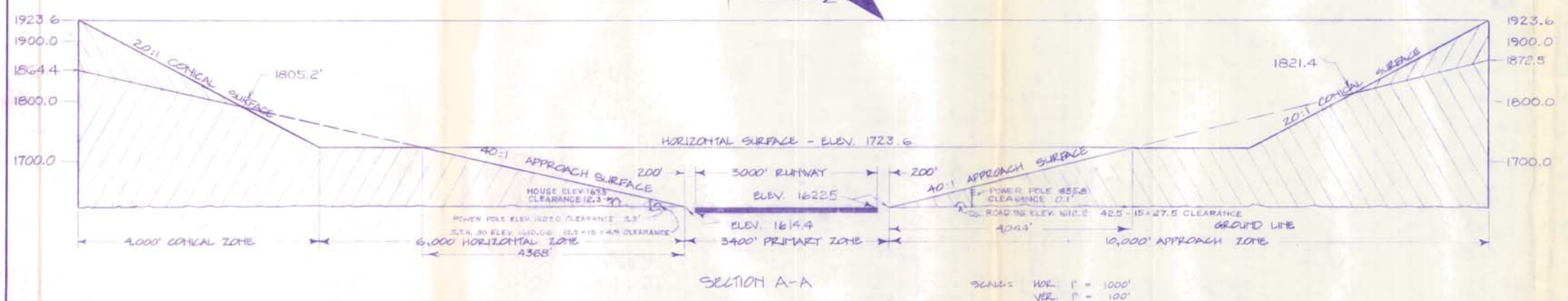
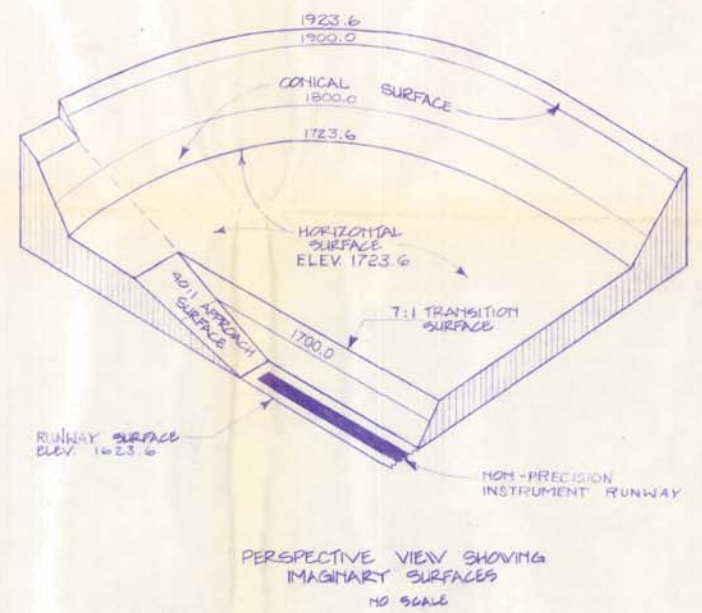
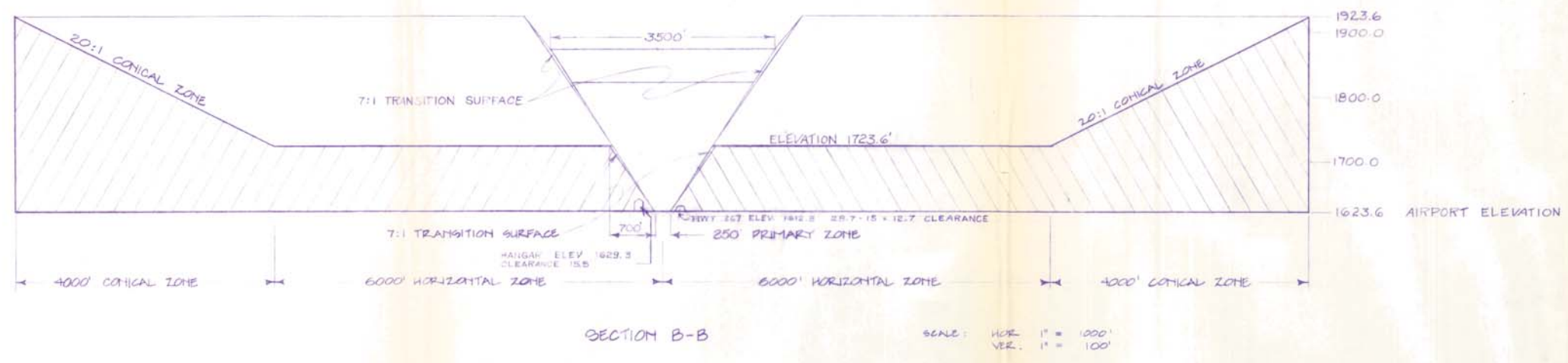

I hereby certify that this plan, specification, or report was prepared by me or under my direct supervision and that I am a duly Registered Professional Engineer under the laws of the state of Minnesota.

Paul Johnson
Date: 5/18/76 Reg. No. 12090

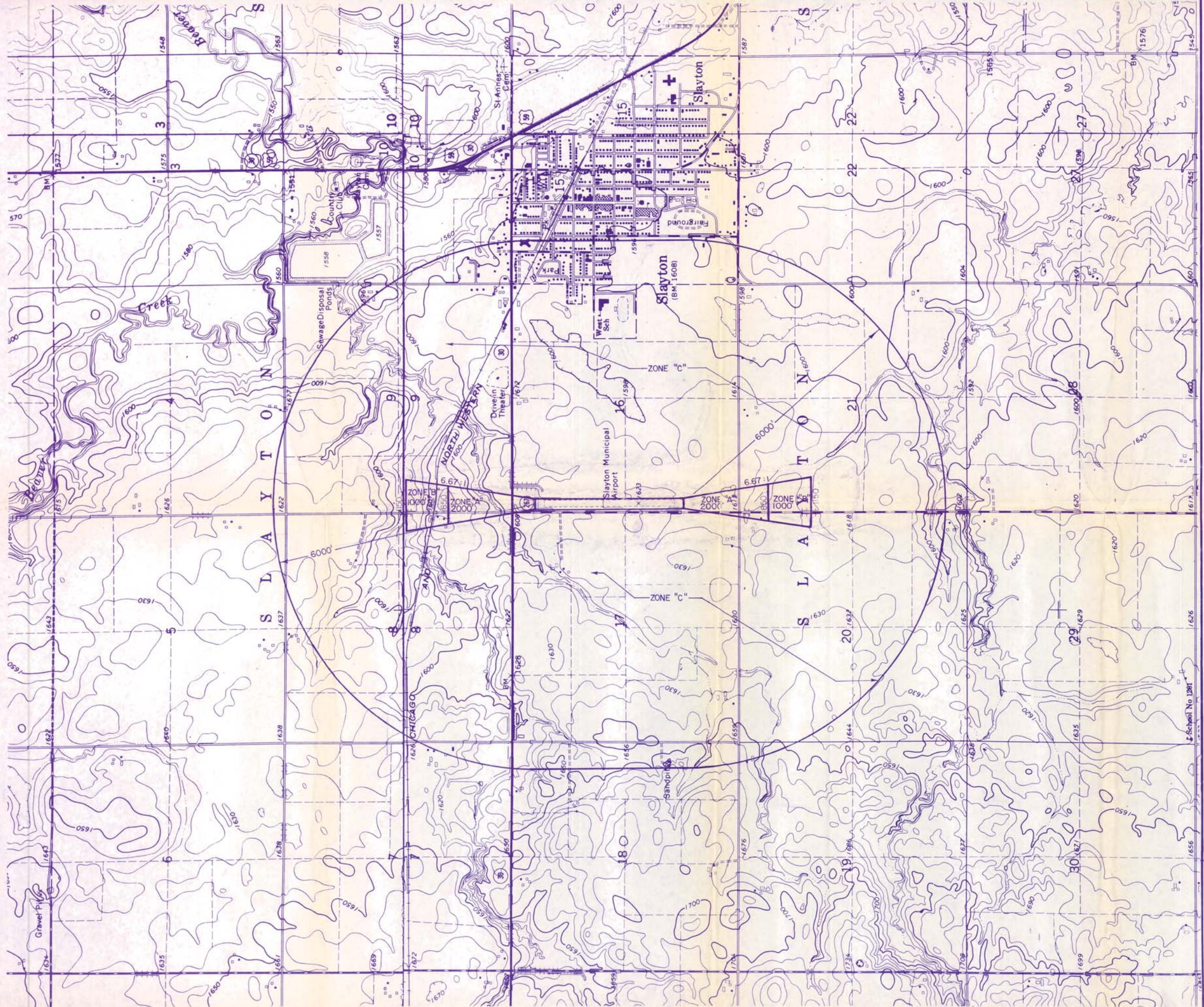

LTM GRID AND 1969 MAGNETIC NORTH DECLINATION

SCALE: 1" = 1000'

LEGEND

- ZONE BOUNDRIES
- TOPOGRAPHIC CONTOURS
- AERIAL CONTOURS
- SECTION LINES
- MEDIUM DUTY ROAD
- LIGHT DUTY ROAD
- UNIMPROVED DIRT ROAD
- STATE ROUTE

NOTES

1. TOPOGRAPHIC CONTOUR INTERVALS ARE 10 FEET. DATUM IS MEAN SEA LEVEL ELEVATION. BY PHOTOGRAMMETRIC METHODS FROM AERIAL PHOTOGRAPHS TAKEN 1966. FIELD CHECKED 1969. 1972 NORTH AMERICAN DATUM.
2. EXISTING TOPOGRAPHICAL SYMBOLS ARE THOSE USED BY THE U.S. GEOLOGICAL SURVEY.

**KOEHNLEIN
LIGHTWOLVER
JOHNSON**
REGISTERED
ARCHITECTS
ENGINEERS

11 SOUTH 10th STREET
ST. LOUIS, MISSOURI 63104
PHONE: 434-1800

CALLED: JOHN W. JOHNSON
MAY 1978
WORKING ARCHITECTS: 2049
PHONE: 434-1800

NON-CONFORMING USES

1. HOUSE ON NORTH END OF RUNWAY. APPROXIMATELY 1237 FEET FROM THE EDGE OF THE RUNWAY IN ZONE A.
2. POWER POLE APPROXIMATELY 637 FEET OFF THE NORTH END OF THE RUNWAY IN ZONE A. POWER LINE ON THE NORTH SIDE OF STATE ROUTE 30 RUNNING PARALLEL WITH THE ROAD.
3. POWER POLE APPROXIMATELY 1334 FEET OFF THE SOUTH END OF THE RUNWAY IN ZONE A.

LAND USE ZONING MAP

**SLAYTON
MUNICIPAL
AIRPORT
ZONING**

SHEET 3 OF 3